

# Vermont Islands

## 7206-3

### Options

Vinyl Cover Black  
 SS Tray Rail  
 Shelf & Sneezeguard  
 LED light under shelf

### Description

Solid Ipe "ironwood" outdoor hot buffet cabinet.  
 Stainless steel top.  
 Locking storage.  
 Interior shelf (right side)  
 3 individually controlled insulated electric hot wells with manifold drain.

### Special

Add 12' quick connect garden hose to drain (after valve)

### Overall Dimensions

74 3/4" x 32 3/4" x 38 3/8"

### Weight

650 lbs

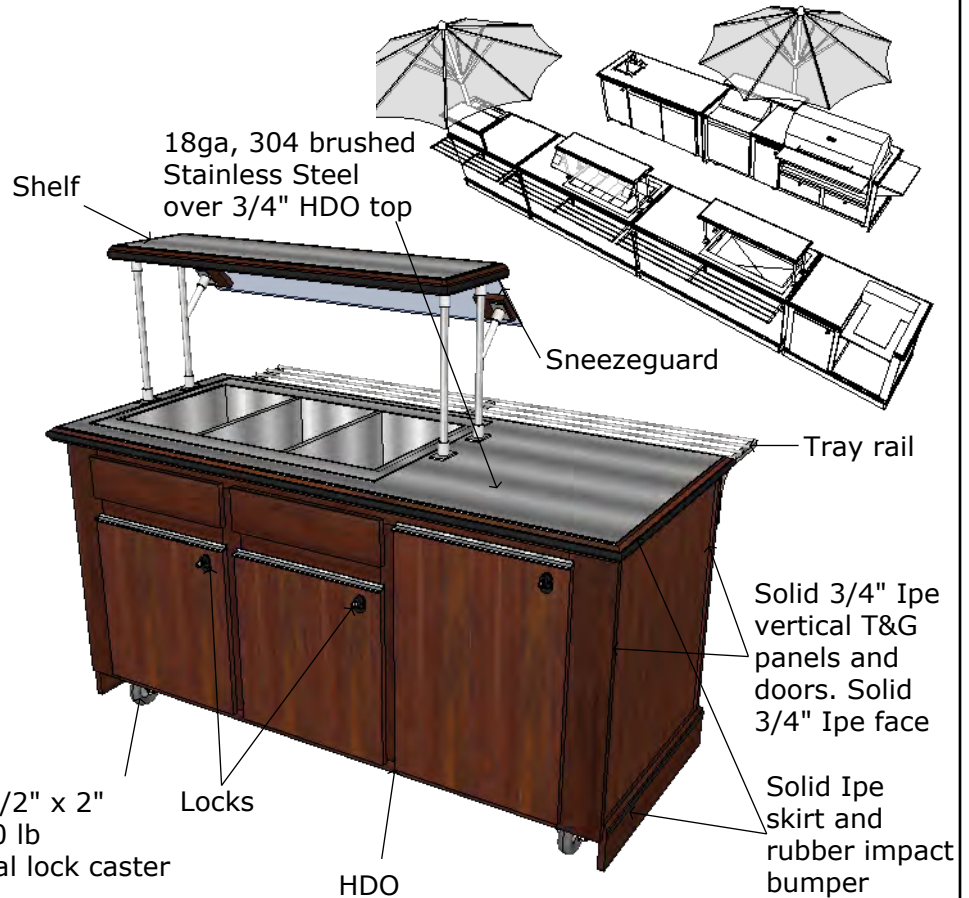

5 1/2" x 2"  
 350 lb  
 total lock caster

Locks

HDO  
 vented  
 bottom

4' 1/4"

Solid 3/4" Ipe  
 vertical T&G  
 panels and  
 doors. Solid  
 3/4" Ipe face

Solid Ipe  
 skirt and  
 rubber impact  
 bumper

Top View

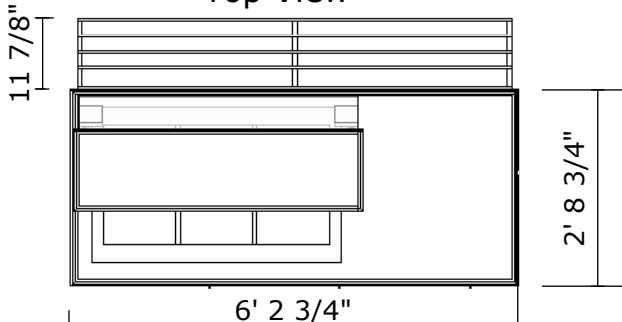

Back View

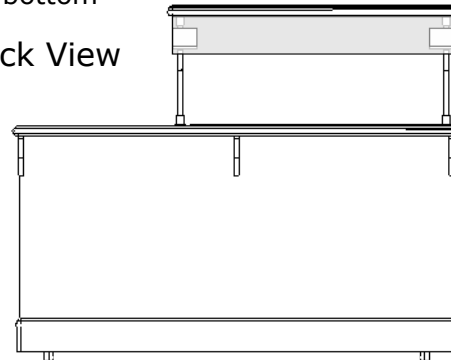

Front View

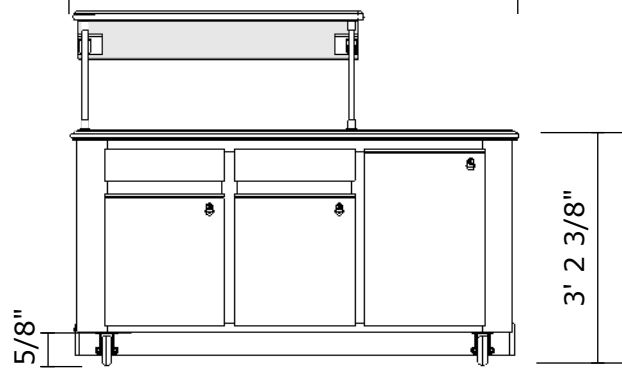

Section

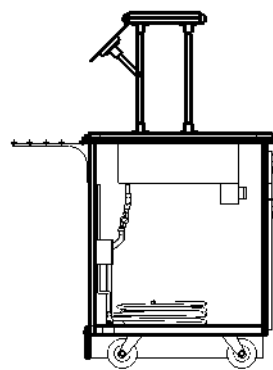

Side View

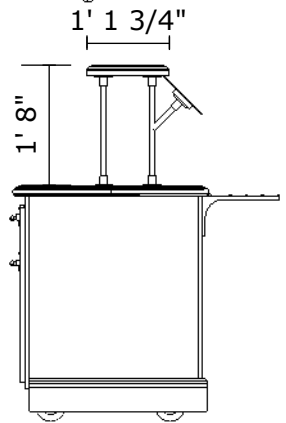

# Vermont Islands 7206-3

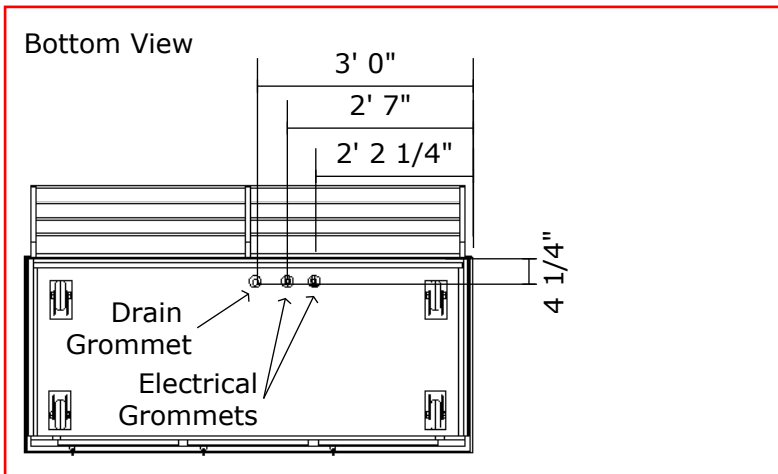
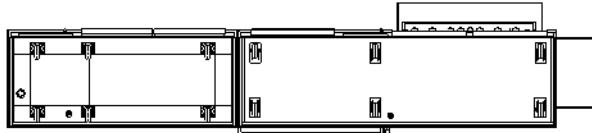
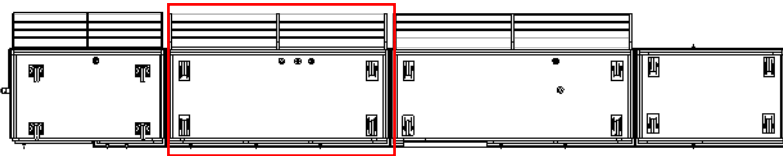

## Appliances

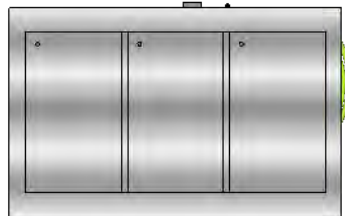
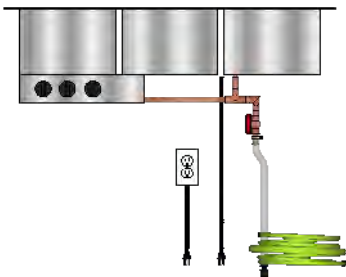

**Vollrath 3 Well Hot Well  
Model 3640450**  
 Separate Infinite Controls  
 Drain Manifold  
 120V / 15.6 Amps  
 625W per well  
 NEMA 5-20P Plug Type



LED light under shelf

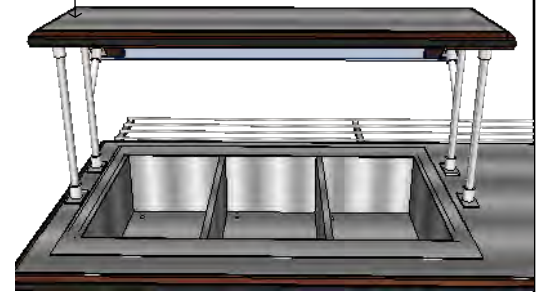

## Plumbing

Flexible drain tube  
 Garden Hose Quick-Connect  
 Garden Hose (12')

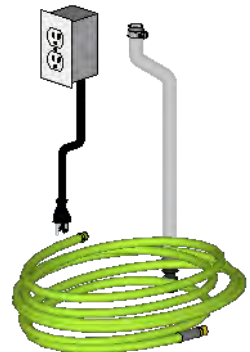

## GFCI Outlet

20 Amp  
 8' Cord w/ NEMA 5-15 plug

Shop Drawings - OK for production

Approved \_\_\_\_\_

Date \_\_\_\_\_